

FOR IMMEDIATE RELEASE - October 23, 2025

Contact: Aria Cochran, Waterfront Alliance, acochran@waterfrontalliance.org

New Vision for a Resilient Flushing Meadows Corona Park Unveiled

Waterfront Alliance Releases Study Proposing Nature-Based Solutions to Address Flooding and Climate Impacts



*Overall proposed concept for a Resilience Vision for Flushing Meadows Corona Park
Credit: Waterfront Alliance, SCAPE, AKRF*

NEW YORK, NY – Waterfront Alliance has released the **Flushing Meadows Corona Park Resilience Study**, a bold new vision to address chronic flooding and prepare one of New York City’s most iconic parks for the challenges of climate change. The report was prepared with support and feedback from NYC Parks, as both entities look toward improving the resiliency and climate readiness of one of the most widely used, diverse parks in all of Queens.

At the heart of the study are two transformative ideas: **daylighting Flushing Creek**—bringing the buried waterway back to the surface—and **reshaping Meadow Lake** to hold more water and create space for wetlands, elevated pathways, and improved park access. Together, these nature-based strategies aim to reduce flooding, restore habitat, and make the park more resilient and enjoyable for all.

“Flushing Meadows Corona Park is a beloved public space that faces mounting pressure from rising seas, stronger storms, and aging infrastructure,” said **Joseph Sutkowi, Chief Waterfront Design Officer for Waterfront Alliance**. “Our vision embraces water as a defining feature of the park’s future—working with nature, not against it, to ensure this landscape thrives for generations to come.”

Today, portions of the park—including soccer fields, walking paths, and open lawns—routinely flood after heavy rains. By restoring natural water systems and expanding Meadow Lake’s capacity, the park could better manage stormwater, improve water quality, and recover faster after floods.

Community engagement played a major role in shaping the study. Over two summers, Waterfront Alliance hosted dozens of events, surveyed hundreds of park visitors in six languages, and incorporated local feedback about flooding, park amenities, and climate resilience priorities.

The *Flushing Meadows Corona Park Resilience Study* aligns with citywide adaptation priorities, complementing recent calls for capital investment such as the Center for an Urban Future’s *The Park Queens Deserves*, which identifies daylighting Flushing Creek as a key opportunity to address flood vulnerability.

The proposals are conceptual at this stage, intended to guide future engineering, design, and funding discussions among City agencies, elected officials, and community partners.

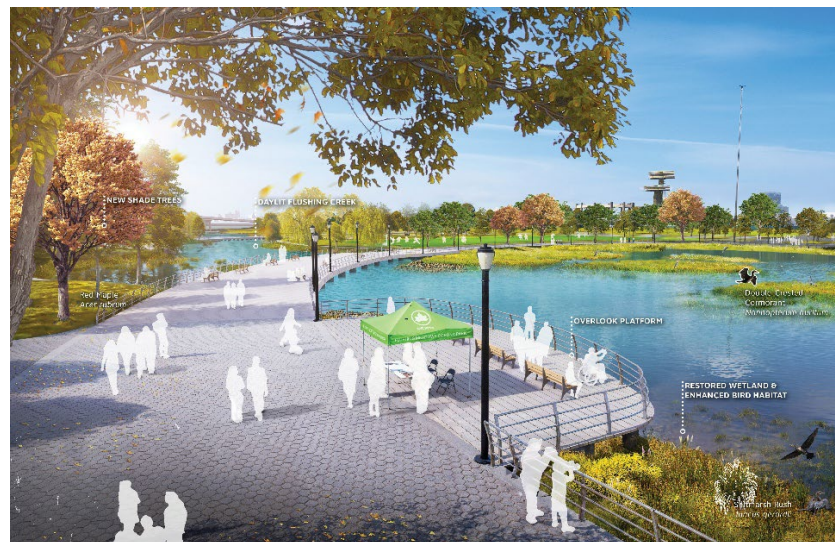

Rendering of New Upland Space along daylight Flushing Creek.

Credit: Waterfront Alliance, SCAPE, AKRF

"I'm proud to have secured more than half a million dollars to help the Waterfront Alliance launch such a crucial project to better protect Flushing Meadows Corona Park, which is one of the greatest pieces of open space across the entire city," said **U.S. Rep. Grace Meng (D-Queens)**. "Mitigating the flooding that frequently occurs in the park is a key component to preserving this beautiful spot and ensuring its use for future generations. From combatting the problem to addressing other impacts of climate change, I look forward to continued efforts to improve Flushing Meadows Corona Park. It is an honor to partner with the Waterfront Alliance, and I thank the organization for its tremendous work in developing a new vision of resiliency."

"As Queens knows first-hand, climate change is the most consequential crisis of our time. So we must leave no stone unturned to protect our borough from its impacts by ensuring our open spaces, like Flushing Meadows Corona Park, remain resilient and can be used for generations to come," said **Queens Borough President Donovan Richards Jr.** "I'm proud to champion any initiative that does just that, including the nature-based initiatives posed in Waterfront Alliance's new resilience study with NYC Parks. We must work together to prevent flooding and other impacts of our changing climate, and this study provides a great blueprint to do just that."

"Flushing Meadows Corona Park is a crown jewel of Queens, and as we face the challenges of a changing climate, it is all the more important to explore innovative resiliency solutions to protect and enhance this treasured greenspace for future generations," said **NYC Parks Commissioner Iris Rodriguez-Rosa**.

"It's appalling that such a vital asset for our city is chronically flooded. Kudos to Waterfront Alliance for putting forward these thoughtful ideas to address the critical, but long overlooked, infrastructure challenges facing Flushing Meadows Corona Park. City leaders should swiftly embrace these solutions." - **Jonathan Bowles, Executive Director, Center for an Urban Future**

"After years of advocating for daylighting the buried portion of Flushing Creek," said **Rebecca Pryor, Executive Director of the Guardians of Flushing Bay (GoFB)**, "GoFB is heartened to see daylighting emerge as a core priority of the FMCP resilience plan. Daylighting tackles flooding in a transformative way and with tremendous benefits for local ecologies and communities: improving water health, managing stormwater, increasing habitat, and connecting people to their waterway. We are proud to have played a part in this proposal's current and continued development."

"We're proud to collaborate with the Waterfront Alliance, NYC Parks, and SCAPE to bring a nature-based vision to Flushing Meadows Corona Park that will enhance stormwater storage, improve water quality, and create a more climate-resilient park for the community to enjoy long into the future," said **Patrick Parault P.E., Senior Vice President, AKRF**.

"Flushing Meadows was once a thriving wetlands and free flowing creek that filtered and absorbed stormwater. Filled with ashes and debris and then developed for the World's Fairs in the '30s and '60s, the marshes were obliterated and creek was buried, with no safe places for the water to go" says **Kate Orff, FASLA, SCAPE Founder**. "This resilience framework daylight the creek to serve as critical ecological infrastructure, stitches together missing connections in its path system and will help direct storm water to a connected creek so that people can continue to enjoy one of New York City's greatest public parks."

To learn more and view the full report, visit bit.ly/FlushingMeadowsCoronaPark.

Join us for an upcoming webinar on the new study "From Vulnerability to Vision—Exploring the FMCP Resiliency Report (Waterfront Webinar)". Happening Tuesday, November 18 from 12pm-1pm via Zoom. [Register here](#).

Join a rally hosted by the Alliance for Flushing Meadows Corona Park on Monday, October 27 at 10am in Dinkins Circle, FMCP.

Call to action: [Sign the New Yorkers for Parks petition](#) calling upon state, local and federal lawmakers to establish a dedicated 'Flood Fund' for Flushing Meadows Corona Park and reverse decades of public underinvestment.

##

About Waterfront Alliance

The Waterfront Alliance is a nonprofit organization that works to inspire and empower people to take action for resilient, accessible, and equitable coastlines. Through advocacy, design, and community engagement, the Alliance helps shape a future where everyone can safely live, work, and play along our region's waterfronts. Learn more at waterfrontalliance.org.